

**Kaps 500 Adhesive Sealer**

**Front & Rear shock absorber stop**

1. Before accessing any part of the Kaps 500 sealer ensure all electrical and pneumatics services are isolated and disconnected,
2. Remove outer cover for access (see procedure).
3. The front shock absorber stop is a double action stop as a pneumatic cylinder movement is included in the assembly, the stop distance is factory set. The stop is located on the chassis plate directly behind the main front access door assembly.

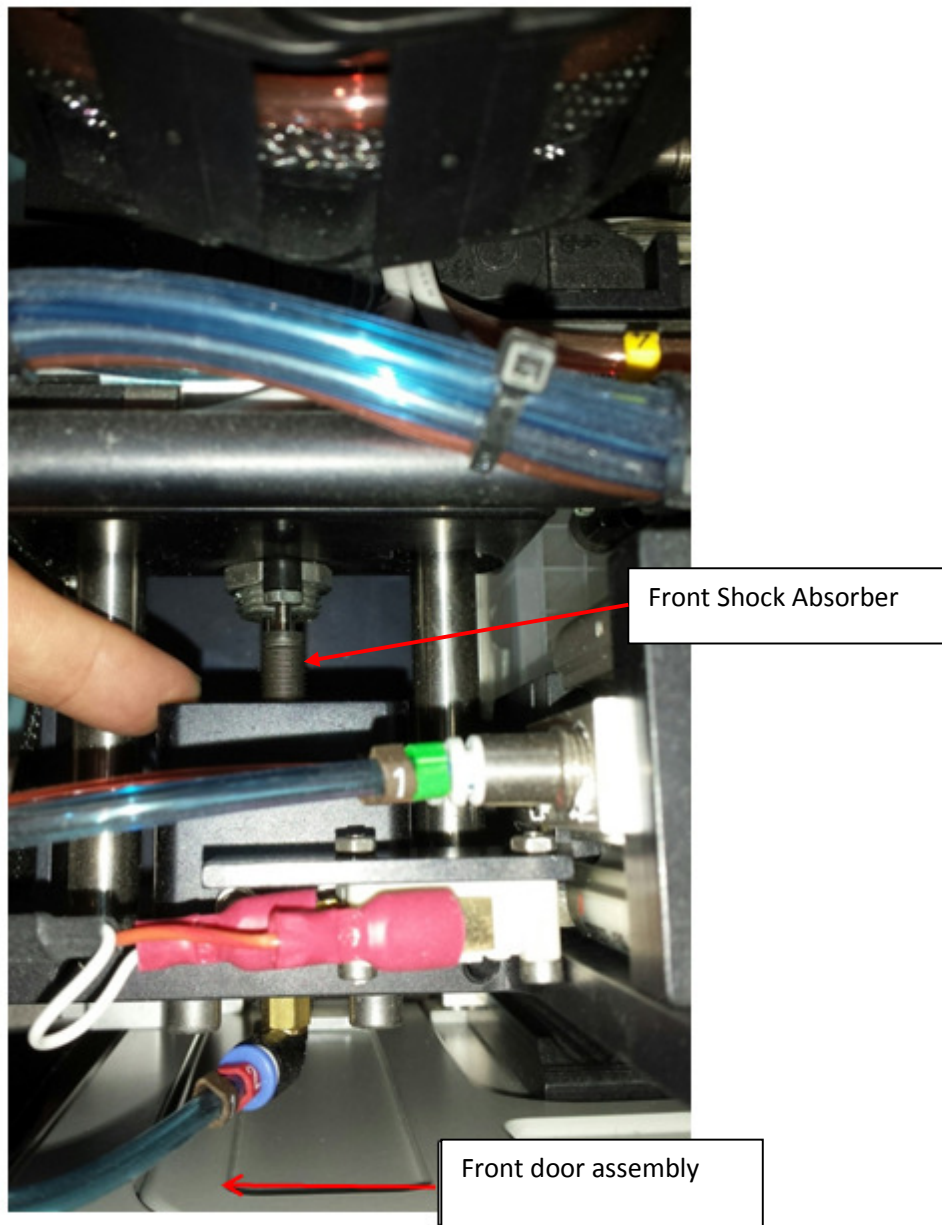

**Kaps 500 Adhesive Sealer**

**Front & Rear shock absorber stop**

4. The rear shock absorber stop is located on the rear cross chassis plate, and can be adjusted. To adjust, loosen the lock nut - rotate the threaded body of the stop in the required direction (1mm pitch – so 1 turn = 1mm movement) re-tighten lock nut.  
The optimum factory set distance is 26.0mm. ( see picture)

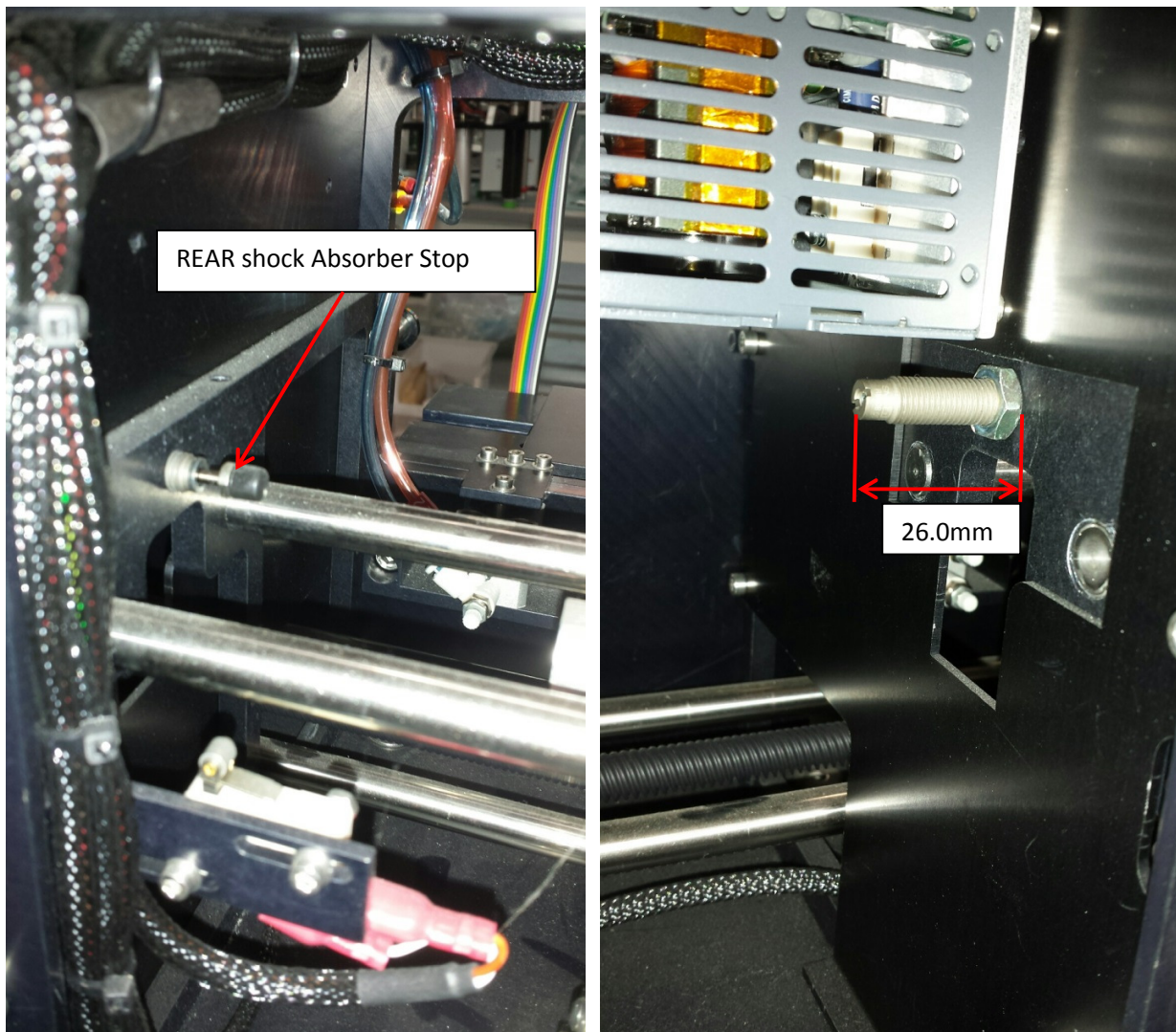

5. Increasing the set distance will move the front vacuum cups / foil pick up towards the rear of unit, and subsequently increase the foil length.
6. Decreasing the set distance will move the front vacuum cups/foil pick up towards the front of unit (closer to cutter blade)and subsequently shorten the foil length.
7. **NOTE: excessive adjustment from the set distance will result in either excessive foil length and failure to pick up foil from cutter ( increasing set distance) or vacuum cups colliding with or being cut by foil cutter blade (decreasing set distance)**